



## Capacitive Sensors S26 Series 80 - PNP

Type of construction Triclamp DN 25

- Easy Teach Push Button
- Housing material: PTFE
- Useable for an ambient temperature up to +100 °C
- With flange connector M 12 x 1



<b>Technical data</b>	Non-flush mountable
Level sensor, in contact with the product	Medium dependent adjustable
Operating distance min. / max. adjustable	0...20 mm
Electrical version	4-pin DC
Output function	Antivalent
<b>Type PNP</b>	<b>KAS-80-26/113-A-TRI-PTFE-100C-Y5-ET-HP</b>
<b>Art.-No.</b>	<b>KA 1214</b>
Operating voltage ( $U_B$ )	10...35 V DC
Voltage drop max. ( $U_d$ )	≤ 2.0 V
Permitted residual ripple max.	10 %
Operating current ( $I_e$ )	2 x 0...200 mA
No-load current ( $I_o$ )	Typ. 15 mA
Frequency of operating cycles max.	Max. 15 Hz
Permitted ambient temperature	-25...+100 °C / CIP 121 °C (zero-current)
LED-display	Green / yellow
Protective circuit	Built-in
Degree of protection IEC 60529	IP 67*
Norm	EN 60947-5-2
Connection	Flange connector M 12 x 1
Housing material	PTFE (FDA 21 CFR 177.1550)
Active surface	PTFE (FDA 21 CFR 177.1550)
Lid	PA
Media optimized	Yes
<b>Accessories</b> (not delivered with the sensor): Stainless steel welding nipple DN 25 # 190751, Sealing gasket # 190752, Triclamp mounting clamp # 190750 and matching connectors please see our selection of accessories.	

Capacitive Sensors S26 with hemispherical active surface for level control of products with a dielectric constant  $\epsilon_r$  as of 1,1. Products can be:

- Bulk material, like plastic granules, powder, cereals, etc.
- Liquids, like water, juice, wine, oil, chemicals or pharmaceutical solutions and much more.
- Pastes in the food processing industry, liquid glue, resins or glue, etc.

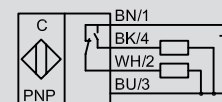

All specifications are subject to change without notice. (02/2017)

\* Position of the EasyTeach button sealed with sealing screw

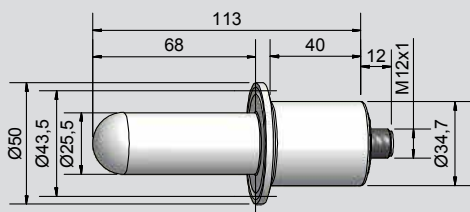

### EasyTeach chart: LED / Output function

Yellow = A1 Green = A2

- [Green pulse] Adjustment "empty"
- [Green square wave] Initializing "empty"
- [Yellow pulse] Adjustment "full"
- [Yellow square wave] Initializing "full"
- [Green pulse] Factory reset
- [Yellow pulse] Test

**Made in Germany**