



LevelMaster - Capacitive Sensors

Model G 1/2"

- For level control of conductive and/or viscous liquids or pastes, for instance oil, water, ketchup or honey.
- Ideal for level control in the Food Industry or Pharmaceutical Industry
- Housing material: Stainless steel VA No. 1.4305 (AISI 303)
- Adjustment of the sensitivity with ETW- Function (EasyTeach by wire)
- With flange connector M 12 x 1
- Welding sockets and Varivent adapter available for EHEDG conform mounting.



Technical data	Non-flush mountable
Sensitivity	Dielectric constant $\epsilon_r > 1.25$
Electrical version	3-pin DC
Output function	Analogue
Typ Analogue	KS-801-26/203-IL4-G1/2-PEEK/VAb-Y3-ETW-HP
Art. No.	KA 1633
Operating voltage (U_B)	12.5...35 V DC
Output signal	4...20 mA
Output current active surface free	≤ 4 mA
Output current active surface covered	≥ 20 mA
Load resistor (R_L)	0...600 Ohm
No-load current (I_0)	Typ. < 30 mA
Permitted ambient temperature	0...+70 °C / CIP 121 °C
Permitted product temperature	0...+100 °C
LED-display	Green / orange
Protective circuit	Built-in
Degree of protection IEC 60529	IP 67, IP 69K
Norm	EN 60947-5-2, EN 60947-5-7*
Connection	Connector M 12 x 1
Housing material	Stainless steel VA No. 1.4305 / AISI 303
Material active surface	PEEK (FDA 21 CFR 177.2415)
Accessories (not delivered with the sensor):	Welding Socket (#196328)
Matching connectors (not delivered with the sensor)	#193391, #193392

Capacitive Sensors S26 for level control of products with a dielectric constant ϵ_r from 1,25. Products can be:

- Liquids, like water, juice, wine, oil, chemicals or pharmaceutical solutions and much more.

Highlights:

- EHEDG conform
- Analogue measuring range max. 120 mm
- Permitted pressure on the active area: 10 bar

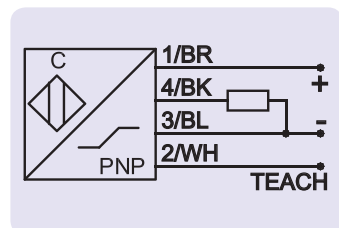

All specifications are subject to change without notice. (15.05.2020)

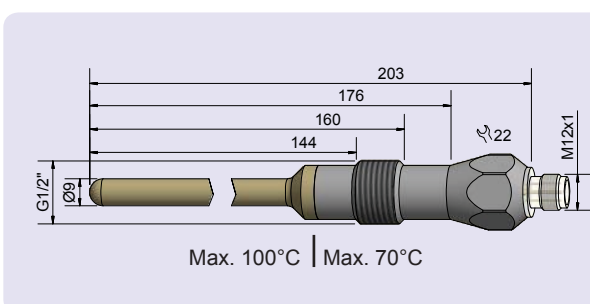

EasyTeach chart:

- Adjustment "empty" (8 sec.)
- Adjustment "full" (20 sec.)
- Test (30 sec.)

*Where applicable

Made in Germany

LevelMaster



This capacitive sensor is designed for the analogue level control of liquid or viscous products, which can be conductive and/or viscous and sticky.

Materials like ketchup, mayonnaise, yoghurt, syrups, pastes, or liquids with salt or acids will be reliably detected with the LevelMaster.



It could not be easier.

The user mounts the sensor, makes the electrical connection and the adjustment by means of the teach wire and the sensor is ready for use.

No additional teach equipment necessary.

Optical guidance during the teach process with the aid of a 2-colour LED:

- standby • teach process • switching state

The modern micro controller controlled temperature compensation provides for reliable level control with applications where there are variations in the ambient temperatures.

The sensor body is made of stainless steel material No. 1.4305 (AISI 303).



To increase the resolution of the measurement a metallic counter electrode is required. This counter electrode establishes a potential reference with the measuring electrode.

Our welding socket (#196328) has been specially developed for this purpose and at the same time offers the possibility for EHEDG-compliant mounting. For an optimal measurement the socket is mounted vertically

With this highly developed technology, this Levelmaster is able to monitor various materials, such as ink or milk, over very long distances.

Thanks to this method, the foam can be easily suppressed when the product is foaming.

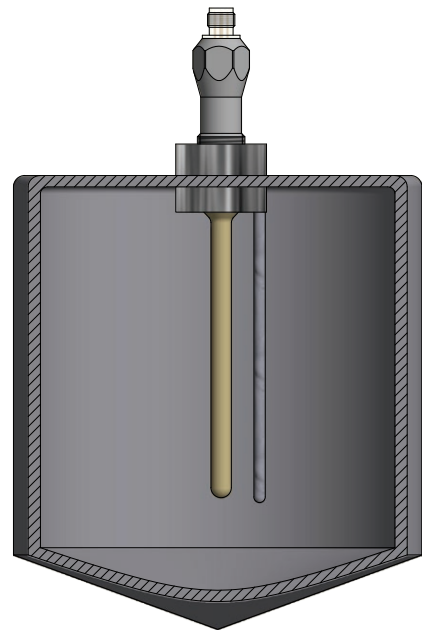

All specifications are subject to change without notice. (15.05.2020)

Made in Germany