

# SH 8 A

## Sensor Holder

- For cylindrical Sensors of  $\varnothing 8$  mm or thread M8
- Simple installation
- Reduced mounting/downtimes thanks to one-piece construction
- Sensor exchange without changing the clamp position
- Limit stop for sensor exchange without readjustment
- Oblong holes permit clamp adjustment

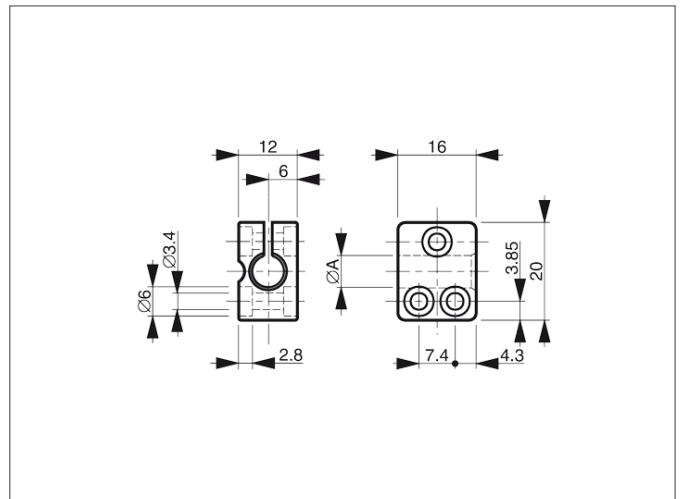

TECHNICAL INFORMATION (typ.)	+20°C, 24V DC
Size	8,0 mm (Clamping diameter A)
Characteristics	with limit stop
Casing material	plastics (polyamide - PA 6 GK)