

SH 12 Sensor Holder

- For cylindrical Sensors of \varnothing 12 mm or thread M12
- Simple installation
- Reduced mounting/downtimes thanks to one-piece construction
- Sensor exchange without changing the clamp position
- Oblong holes permit clamp adjustment

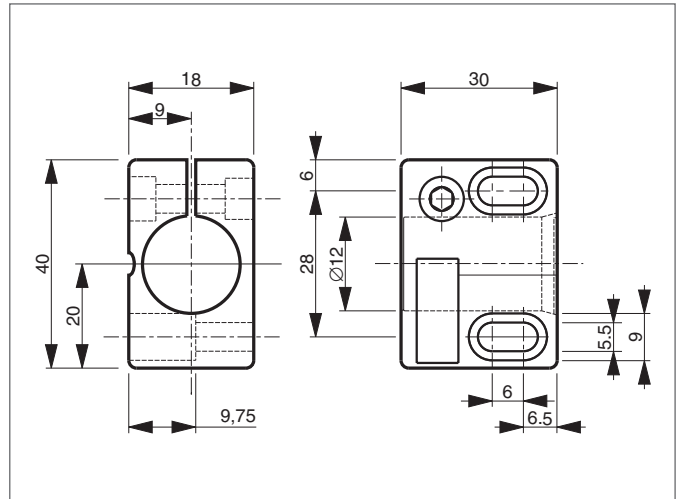

TECHNICAL INFORMATION (typ.)		+20°C, 24V DC
Hole spacing		28 mm
Size		18 x 30 x 40 mm (Dimensions) 12 mm (Clamping diameter G)
Characteristics		without limit stop
Casing material		plastics (polyamide - PA 6 GK)

