

- To operate colour sensors with fibre optic connection
- 高质量玻璃纤维
- Arrangement of fibres statistically mixed
- 耐高温
- 结实耐用，灵活度高

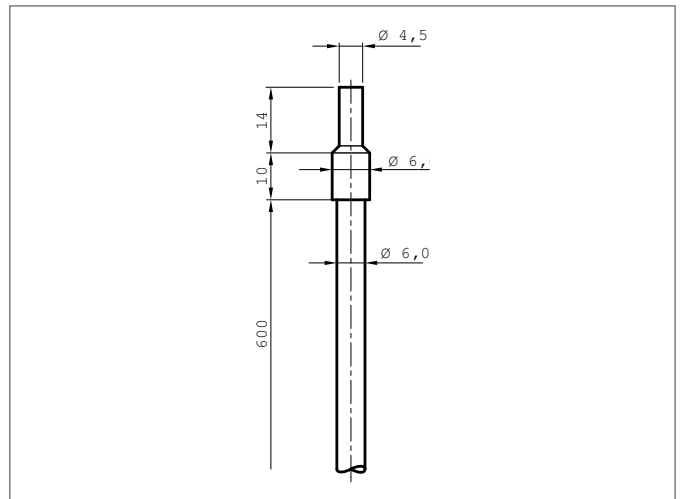
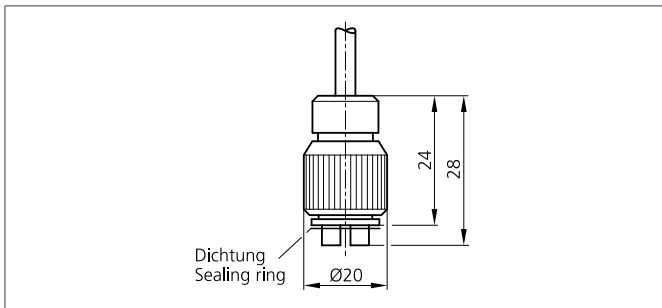

Safety instructions

The Instruments are not to be used for safety applications, in particular applications in which safety of persons depends on proper operation of the instruments. These instruments shall exclusively be used by qualified personnel.

TECHNICAL INFORMATION (typ.)		+20°C, 24V DC
操作原理		漫反射传感器
设计		螺纹设计
长度		600 mm, (fiber optic cable)
有效直径		2,5 mm
开口角度		67 °
发光口		轴向
安装孔		4.5 mm
单光纤		0.05 mm
弯曲半径		> 3 x 管直径
负载振荡		10 ... 55 Hz / 1,0 mm / 30 g
耐xx温		-40 ... + 180 ° C (短期可达 +250 ° C)
防护等级		IP 67
为了		颜色传感器, Amplifier for glass fiber optics
材料		Stainless steel (传感器探头) glass fiber (纤维) Silicone-metal sleeve (包层)