

# DCC 05 V 1.5 PSK-TSL

## Inductive Proximity Switch

- Stainless steel casing
- Integrated amplifier
- Short-circuit protection
- Starting pulse suppression
- LED
- Metal plug

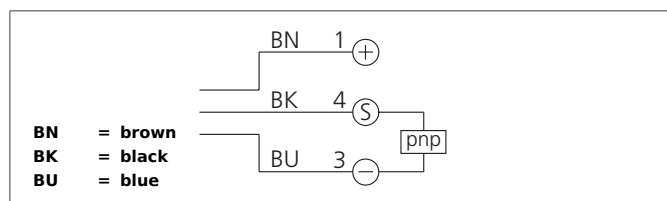
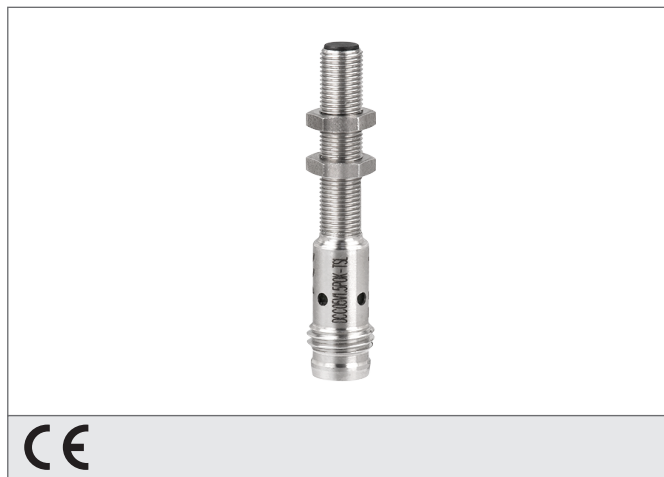

### Safety instructions

The Instruments are not to be used for safety applications, in particular applications in which safety of persons depends on proper operation of the instruments.

These instruments shall exclusively be used by qualified personnel.

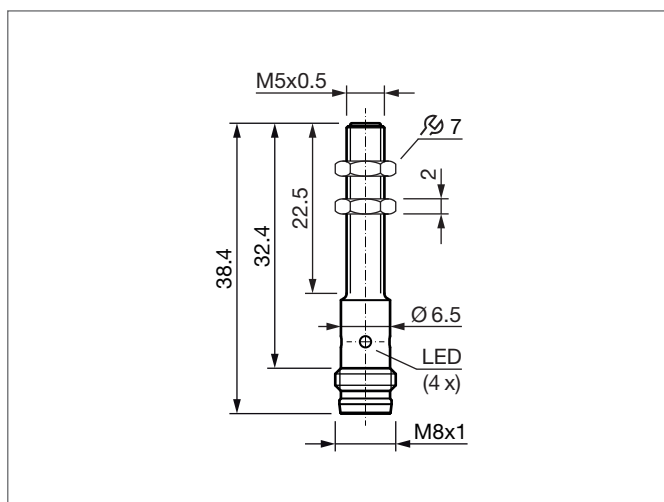

TECHNICAL INFORMATION (typ.)		+20°C, 24V DC
Operating principle		Inductive
Evaluation		digital
Size		M5 x 0,5 (thread)
Design		screw
Mounting		flush
Characteristics		increased operating distance
Operating distance		1,5 mm
Standardized measuring plate		5 x 5 x 1 mm
Service voltage		10 ... 30 V DC
No-load current		< 10 mA
Switching output		pnp, 100 mA, NO
Switching hysteresis		1 ... 20 %
LED indicator		yes
Voltage drop		< 1,5 V
Switching frequency		5000 Hz
Reproducibility		5 % (UB = 20 ... 30 V DC, TA = 23°C ± 5°)
Ambient temperature, operation		-25 ... +70 °C
Insulation voltage endurance		500 V
Protection class		IP 67
Casing material		stainless steel V2A (1.4305 / AISI 303)
Material		PBT (Sensor probe)
Connection		Connector, M8