

DCC 05 V 0.8 NSLK

Inductive Proximity Switch

- Cable, highly flexible
- Integrated amplifier
- Short-circuit protection
- Starting pulse suppression
- LED

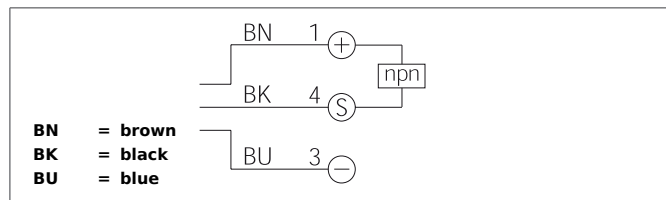
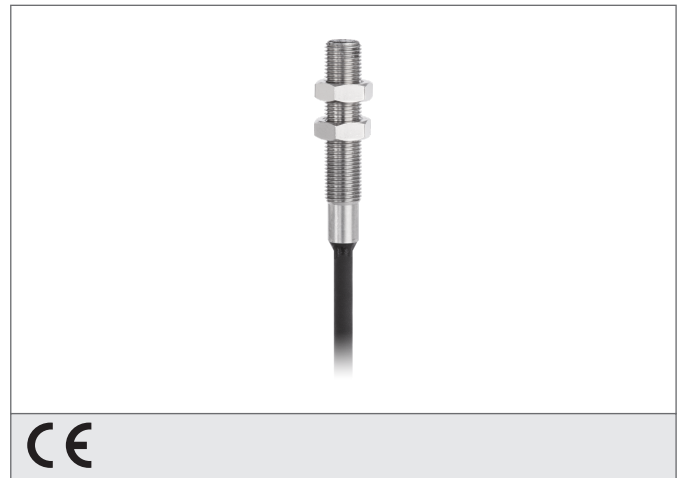

Safety instructions

The Instruments are not to be used for safety applications, in particular applications in which safety of persons depends on proper operation of the instruments.
These instruments shall exclusively be used by qualified personnel.

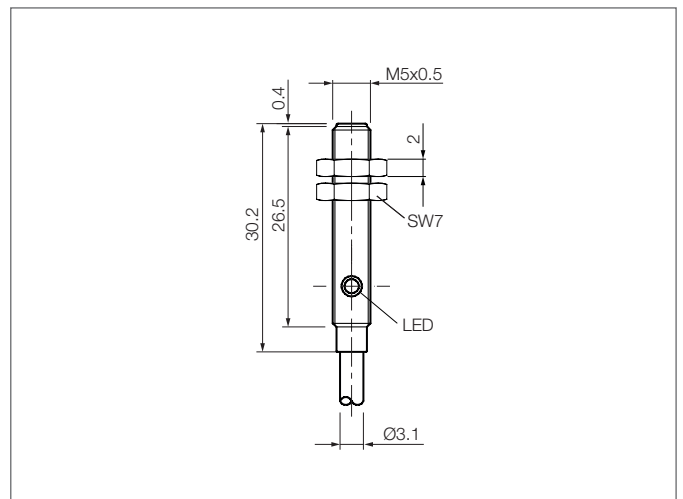

TECHNICAL INFORMATION (typ.)		+20°C, 24V DC
Operating principle		Inductive
Evaluation		digital
Size		M5 x 0,5 (thread)
Design		screw
Operating distance		0,8 mm
Standardized measuring plate		5 x 5 x 1 mm
Service voltage		10 ... 30 V DC
No-load current		< 10 mA
Switching output		npn, 100 mA, NO
Switching hysteresis		< 20 % Sr
Switching frequency		5000 Hz
Ambient temperature, operation		-25 ... +70 °C
Protection class		IP 67
Casing material		stainless steel
Material		PUR (Cable)
Connection		Cable, 2,0 m