

7/8" Mini-Receptacle Connectors, Front Mount, IEC Color Code

RSF.../11 | RSF.../13.5 | RKF.../11 | RKF.../13.5



Male, 2-, 3-, 4-, and 5-Pole

Receptacle connector, 7/8"-A body, male 2-, 3-, 4-, and 5-pole for front mounting, assembled stranded wire, potted with epoxy, chassis side thread PG11 or PG13.5, screw connection (panel nut RSKF 11 or RSKF 13.5).

RSF.../11

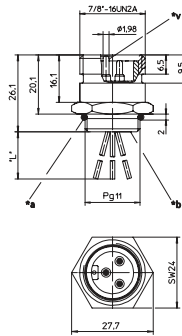

*a O-ring enclosed separately
*b solder contacts potted with epoxy
*L 0.3 m

RSF.../13.5

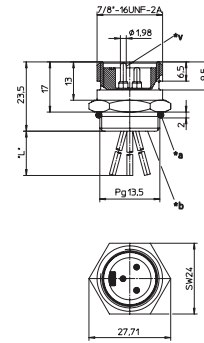

*a O-ring enclosed separately
*b solder contacts potted with epoxy
*v center contact leading
*L 0.3 m



Female, 2-, 3-, 4-, and 5-Pole

Receptacle connector, 7/8"-A body, female 2-, 3-, 4-, and 5-pole for front mounting, assembled stranded wire, potted with epoxy, chassis side thread PG11 or PG13.5, screw connection (panel nut RSKF 11 or RSKF 13.5).

RKF.../11

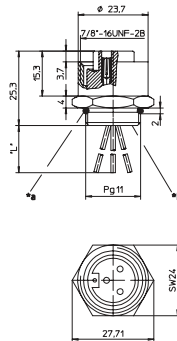

*a O-ring enclosed separately
*b solder contacts potted with epoxy
*L 0.3 m

RKF.../13.5

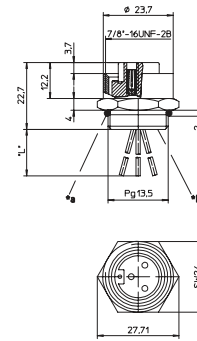

*a O-ring enclosed separately
*b solder contacts potted with epoxy
*L 0.3 m

Pin Assignments

Face Views, 7/8"-Male / Female

2 pole

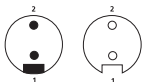

1 = brown
2 = blue

3 pole

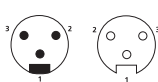

1 = brown
2 = black
3 = blue

4 pole

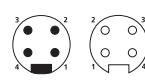

1 = brown
2 = white
3 = blue
4 = black

5 pole

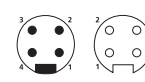

1 = black
2 = blue
3 = green/yellow
4 = brown
5 = white



Be Certain with Belden

7/8" Mini-Receptacle Connectors, Front Mount, IEC Color Code

RSF.../11 | RSF.../13.5 | RKF.../11 | RKF.../13.5

Technical Data

Environmental











Degree of protection IP 68 / NEMA 6P
 Operating temperature range -25°C (-13°F) / +90°C (+194°F)

Mechanical

Housing / Molded body CuZn, nickel-plated
 Insert TPU, self-extinguishing
 Contact CuZn, silver-plated and 0.3 microns gold-plated

Electrical

Contact resistance $\leq 5 \text{ m}\Omega$
 Nominal current at 40°C
 2-3 poles 12 A
 4-5 poles 9 A
 Nominal voltage 240 V
 Rated voltage 250 V
 Test voltage
 3-4 poles 2.5 kV eff. / 60 s
 5 poles 1.5 kV eff. / 60 s
 Insulation resistance $> 10^9 \Omega$
 Pollution degree 3

| Part Number | | | | Pins | Lead (mm ²) | Characteristics |
|--------------|----------------|--------------|----------------|------|-------------------------|---|
| Male PG11 | Male PG13.5 | Female PG11 | Female PG13.5 | | | |
| RSF 20/11-03 | RSF 20/13.5-03 | RKF 20/11-03 | RKF 20/13.5-03 | 2 | 0.75 |   |
| RSF 30/11-01 | RSF 30/13.5-01 | RKF 30/11-01 | RKF 30/13.5-01 | 3 | 0.75 |   |
| RSF 30/11-05 | RSF 30/13.5-05 | RKF 30/11-05 | RKF 30/13.5-05 | | 0.75 |   |
| RSF 40/11-02 | RSF 40/13.5-02 | RKF 40/11-02 | RKF 40/13.5-02 | 4 | 0.5 |   |
| RSF 50/11-04 | RSF 50/13.5-04 | RKF 50/11-04 | RKF 50/13.5-04 | 5 | 0.5 |   |